

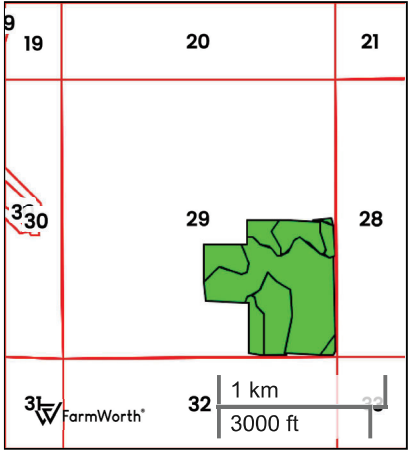

127.27 ACRES OWNED WITH GROUP

# TILLABLE SOILS

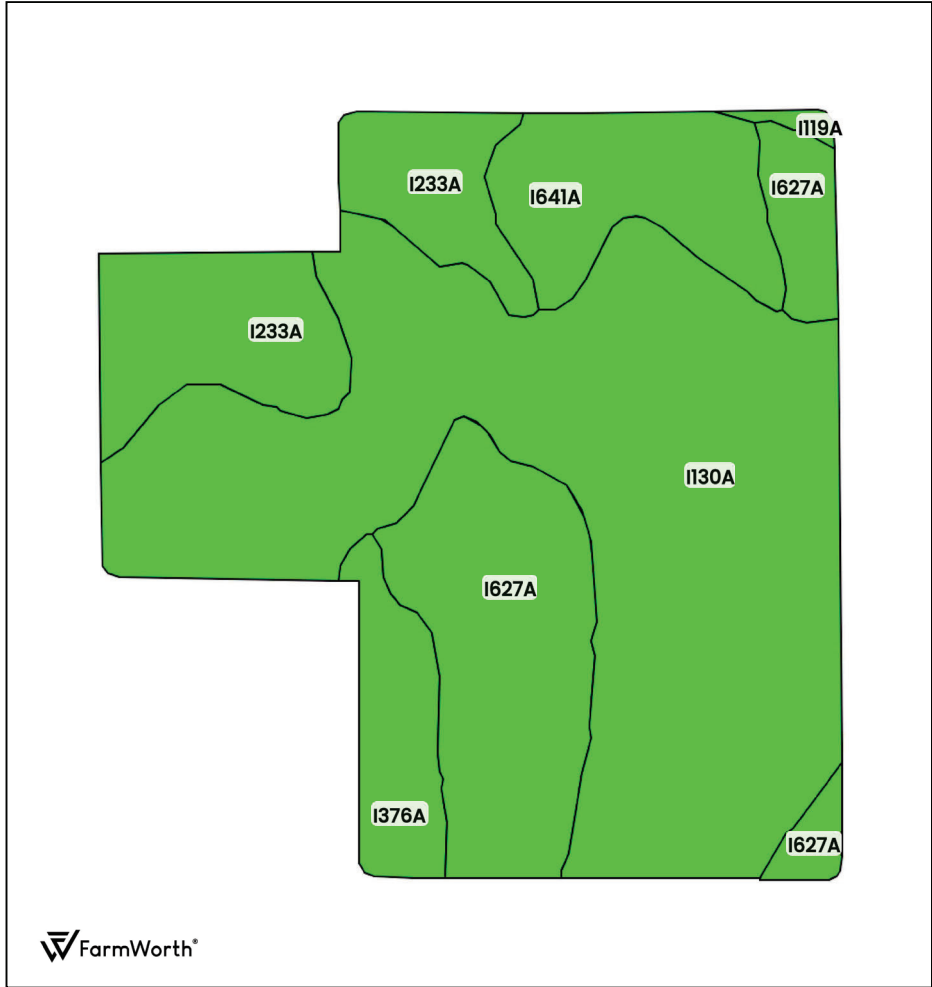

County: **Clay County, MN**  
 Location: **29-139N-48W**  
 Township: **Moorhead**  
 Acres: **121.38**  
 Date: **03/25/2026**



FarmWorth, LLC makes no warranties, express or implied, regarding the accuracy of any information provided through FarmWorth.com. User is solely responsible for independently verifying all information prior to use and waives any claims against FarmWorth, LLC arising from inaccuracies in such information.

Code	Description	Acres	% of field	MN CPI	Soil Class (Non-Irr)
I130A	Hegne-Fargo silty clays, 0 to 1 percent slopes	64.77	53.36 %	88	2
I627A	Bearden-Fargo complex, 0 to 2 percent slopes	22.73	18.73 %	93	2
I233A	Fargo silty clay loam, 0 to 1 percent slopes	16.17	13.32 %	95	2
I641A	Fargo silty clay, silty substratum, 0 to 1 percent slopes	10.78	8.88 %	94	2
I376A	Colvin silty clay loam, 0 to 1 percent slopes	6.46	5.32 %	89	2
I119A	Bearden silty clay loam, 0 to 2 percent slopes	0.47	0.39 %	93	2
<b>Average:</b>				<b>90.5</b>	

MN Productivity Index tables are obtained from the [NRCS Field Office Technical Guide](#)  
 Soils data provided by USDA and NRCS.